

SMARTINTEGO ONLINE MECATRONIC

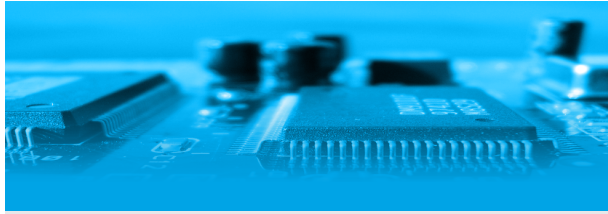

PRODUCT DATASHEET



Highlights

EASY IMPLEMENTATION

Installation is quick, with no wiring at the door. No door modifications are required. View alarm feedback and status, depending on the model, in real time on MICROSESAME, as shown in the table overleaf.

SITE BADGES RETAINED

Users are more comfortable because they no longer have keys but a single badge. Access rights management is easy, centralised and can be modified on a single MICROSESAME HMI interface, and information is exchanged in real time.

AUTONOMOUS LOCK

In the event of a link failure with the controller, the lock switches to autonomous mode: up to 128 pre-loaded emergency badges for all locks and storage of the last 1,000 events in each lock.

Main characteristics

- Wireless 868 MHz radio connection of a controlled door to the MICROSESAME centralised system.
- Direct connection of RS485 radio hubs to a dedicated bus on the TILLYS CUBE controller, which can manage up to 8 locks, i.e. up to 24 locks per TILLYS CUBE.
- A single SMARTINTEGO radio hub can manage up to 8 mechatronic radio locks
- Automatic integration with MICROSESAME (rights management, traceability, history, etc.)
- Technologies managed: MIFARE & DESFIRE UID (both simultaneously), a single secure MIFARE & DESFIRE mapping without diversification, (both simultaneously if in the same TECHNO in MS)



Flexibility and high security



The SMARTINTEGO range includes mechatronic lever handles and cylinders. These are wireless locking devices that combine an access control reader with an electric locking system. The reader is 13.56 MHz compatible (MIFARE, DESFIRE).

This makes it easier to connect a large number of internal doors, or doors with high wiring constraints.

The SMARTINTEGO online range includes: SH lever handle, AX cylinder, AX handle, AX padlock, AX lock, the 868 MHz radio HUB and the programming and pairing kit for SMARTINTEGO ONLINE locks on the RS485 bus. This kit includes :

- SMARTINTEGO SI.SW programming software
- USB-RS485 configurator for setting up radio hubs
- USB-radio programmer for setting lever handle and cylinder parameters
- 10 Desfire badges for creating emergency badges

HANDLE, CYLINDERS, WIRELESS RADIO LOCKS

RIGHTS MANAGEMENT	ONLINE SYSTEM	OFFLINE SYSTEM
 OFFLINE + ONLINE	 Reader + Hub radio + LPU	 Reader + Charging point

SMARTINTEGO ONLINE MECATRONIC

Operating diagram

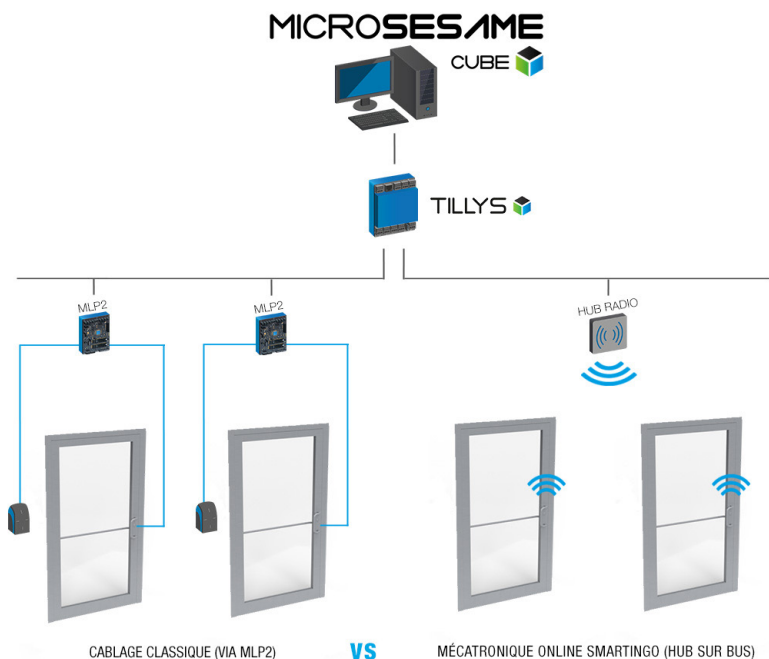

DETAILED SPECIFICATIONS

STATUS / ALARMS	AX RANGE	SH 3062 RANGE
Battery fault	✓	✓
Emergency badge	✓	✓
COM bus HUB fault	✗	✗
Door status	✗	✗
Latch position	✗	✗
Key opening	✗	✗
Handle activation	✗	✗
Disturbance, radio com fault	✗	✗
Auto-protection	✓	✓
Office mode	✓	✓

Références

SMARTINTEGO Online programming

- **PRG05SV01:** Programming and pairing kit for hubs, cylinders and lever handles
SMARTINTEGO ONLINE: SI.SW software + USB-RS485 configurator + USB-radio programmer + badges

Hubs

- **LEC00SV08:** Radio hub for real-time communication with SMARTINTEGO cylinders, lever handles and locks (1 to 8 elements connected) - Compatible with TILLYS CUBE controllers on a dedicated SMARTINTEGO BUS.
- **ANT00SV08:** Radio repeater for connecting remote elements without wiring additional hubs (max 8 elements)

AX Online electronic handles

- **LEC25SV1000-0000:** Electronic handle with reader in high position (key cylinder accessible for overlocking or emergency), right or left hand handle, MIFARE / DESFIRE reader, stainless steel and black colour, battery included
- **LEC25SV2000-0000:** Electronic door handle with long reader in low position (key cylinder covered by RFID reader), right or left hand grip, MIFARE / DESFIRE reader, stainless steel and black colour, battery included

Electronic lever handle SH Online

- **LEC23SVA0000-0000:** Electronic lever handle SH3062 for SNAPIN mounting (can be clipped without drilling the door), blind plate (mandatory), MIFARE / DESFIRE reader, battery included
- **LEC23SVE0000-0000:** Electronic lever handle SH3062 for conventional mounting (door drilling), plate with drilling for European cylinder (for overlocking or emergency), MIFARE / DESFIRE reader, battery included

AX Online cylinders & half-cylinders

- **LEC22SV1000-0000:** AX Stainless steel electronic cylinder, MIFARE / DESFIRE reader, battery included
- **LEC16SV1000-0000:** AX Inox electronic half cylinder, MIFARE / DESFIRE reader, battery included

AX Online lock and padlock (without hub)

- **LEC26SV0100:** Digital locker/drawer cam lock, battery included
Spacer plates adjustable to bolt position + 4 locking inserts of different widths different widths for fine adjustment
- **Consult us:** AX digital padlock, ring diameter 8 mm, internal ring height 60 mm, automatic locking, anti-drilling protection

Contact Commercial : info@til-technologies.fr

Contact Marketing : marketing@til-technologies.fr